



SCHOOL OF DESIGN SEHORE



Empower
your future

A Leading College of Design, of MP

Run under the flagship of
SRI SATYA SAI UNIVERSITY OF TECHNOLOGY
& MEDICAL SCIENCES, SEHORE . M.P.

UNIQUE

A Complete Institute, which cares, nurtures & prepares Indian Architects & Designers of International Level for the World Market.

EXPERIENCE

Run under the flagship of a University with 2 decades of Academic Excellence. Headed by renowned Architect - Planner of Central India, Awarded at National & International level. Highly Experience & Dedicated Principal with 30 years of Academic Excellence

EXCELLENCE

Taught by the best team of highly experienced Professors, Internationally & Nationally acclaimed visiting faculty. The Alumni of IIT's & NID's are engaged in imparting world-class education.



SCHOOL OF DESIGN SEHORE

Most Awarded
& Acclaimed
Architect of Central India



Ar. G. Venkatesh
DIRECTOR
School of Design

WELCOME

Let's explore
your future
& unlock your
potential.



VISION

- + To bring about a transformation through responsible, creative and purposeful designs which prioritizes humankind and its varied cultures by designing products and systems that beautifully unite lessons from the past with visions of the future.
- + To deliver a holistic design education that prepares students to enhance the quality of life for people at all scales ranging from the local to the global.



MISSION

- + Students at The School of Design shall learn to become capable and skilled designers dedicated to solving problems and contributing to the public good.
- + Our approach shall draw on design thinking that ranges from craft economies to technological breakthroughs, with a holistic outlook embodying environmental sensitivity.
- + At the centre of this educational experience shall be the method of project-based learning. It shall allow students to engage with multiple scales, from on-campus research initiatives to national and international partnerships.
- + The School of Design shall be a catalyst in bringing about these changes with a focus on and engagement with critical contemporary issues.
- + Staying aligned with shifts in the global economy, society, and environment, The School of Design shall promote inclusive design for the betterment of all sections of society.



VALUES

The School of Design will be shaped by the following core values.

- + Innovation
- + Collaboration
- + Experimentation
- + Technological fluency
- + Ethics
- + Environmental concerns
- + Market understanding

Vision



STATE-OF-THE-ART CAMPUS



Sprawling over
100 acres of
University Campus



Rich Library



IT Enabled Studios
& Classrooms all enabled
with Online Class Facility



IT Enabled
Workshops with
Teaching Facility



In Campus Hospital,
Medical & School
of Physical
Education Facility



In Campus Canteen
with backup of Institute
of Hotel Managment.



Transport Facility
for students
living upto 200 kms



Excellent Hostel
Facilities for
Girls & Boys



Excellent Gyming
& Sports Facilities



SCHOOL OF DESIGN SEHORE

Run under the flagship of
SHRI SATYA SAI UNIVERSITY OF TECHNOLOGY
& MEDICAL SCIENCES, SEHORE . M.P.

OFFERS 2 COURSES



B DESIGN

- Communication Design
- Fashion Design
- Interior Design

B ARCH



C O U R S E S O F F E R E D

BACHELOR OF ARCHITECTURE

B. Arch - 5 years

Understand yourself to find the Architect within you.
Develop the Architect within you to understand
Architecture. Learn to practise Architecture before
Graduating.

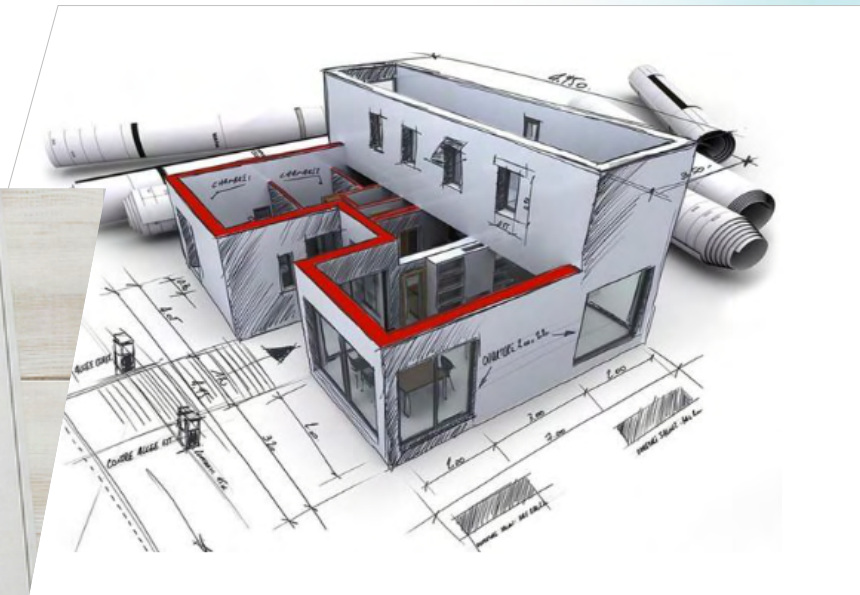
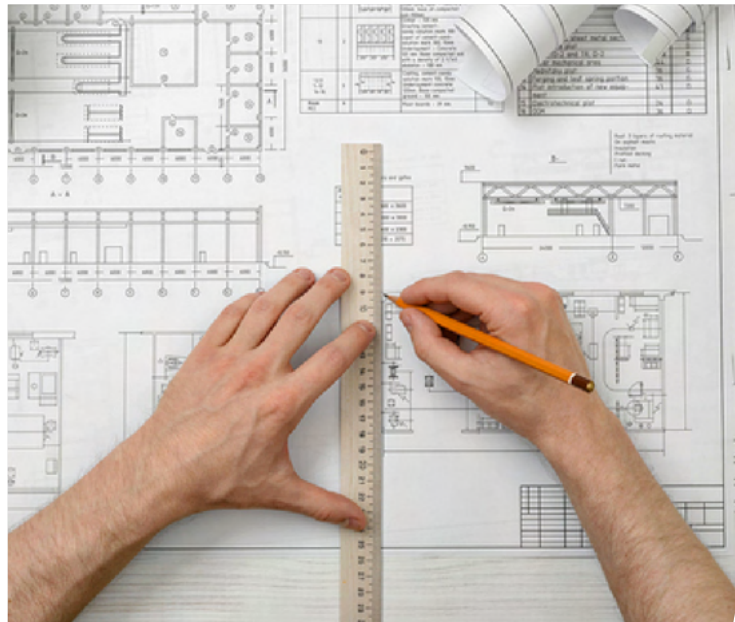

Approved by



Council of Architecture

MOU with



BACHELOR OF DESIGN

C O U R S E S O F F E R E D

COMMUNICATION DESIGN

B. Design - 4 years

Communication Design at School of Design, Sehore transcends the limit of a traditional graphic design curriculum, encompassing everything from typography to complex information mapping. Study of all facets of communication enables you to create meaning & value through media.



BACHELOR OF DESIGN

C O U R S E S O F F E R E D

FASHION DESIGN

B. Design - 4 years

Fashion Design today encompasses much more than the creation of clothing & accessories. School of Design, Sehore trains you to be a complete designer, ready to face the challenges of designing in the 21st century. You evaluate design through societal, cultural, historical and economical lenses developed through interdisciplinary study.



BACHELOR OF DESIGN

C O U R S E S O F F E R E D

INTERIOR DESIGN

B. Design - 4 years

School of Design, Sehore is one of the leading colleges for Interior design education. The Interior Design course prepares you for a career in an increasingly complex field embracing everything from furniture to building scale environments. Working with an acclaimed faculty of top professional designers, you learn to conceive & develop interior designs using representational means ranging from models to full-scale material constructs & digital animations.



THINKING OF
B. DESIGN
B. ARCH

ADMISSIONS OPEN FOR 2021 - 22 SESSION

B Design - Eligibility 12th Pass

B Arch - Eligibility 12th Pass with
Math - Science plus NATA Valid

FOR QUERIES CALL

 Bhopal - Indore Road, Opposite Pachama Oil - fed Plant,
Pachama, Sehore (M.P.) Pin - 466001

 9109812320

 admissions.sod.sssutms@gmail.com

 info@sssutms.co.in

 ecampus.sssutms.co.in/entrance/EnquireFrom.aspx

 web.sssutms.co.in//Document/Download/Sod_BR.pdf



**SCHOOL OF
DESIGN
SEHORE**



RUN UNDER THE FLAGSHIP OF
SRI SATYA SAI UNIVERSITY OF TECHNOLOGY & MEDICAL SCIENCES, SEHORE . M.P.

